

QUICK TRAINING GUIDE: TT-02RX

1 Configure your classroom

Basic Configuration

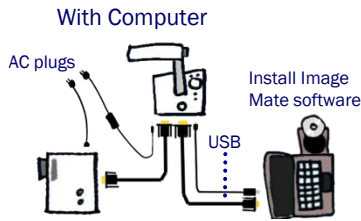
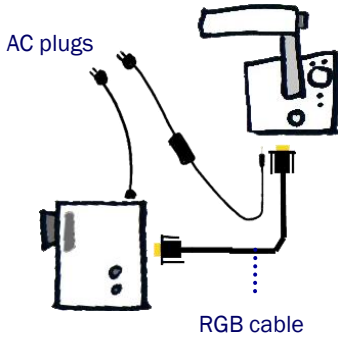

With Interactive Whiteboard



Rear panel

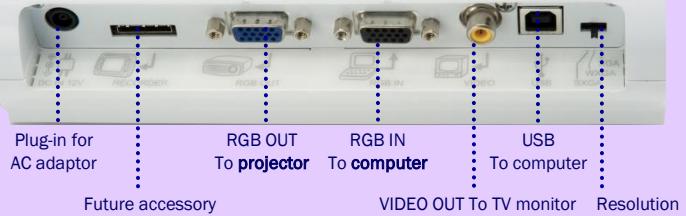

2 Power on the TT-02RX, Zoom and Focus

Twist the zoom knob to zoom in/out



Press the Auto-focus button to focus after zooming.

3 Rotate

Rotate the camera column close to a small object, turn the camera head horizontally to view students giving a presentation, speech, etc.

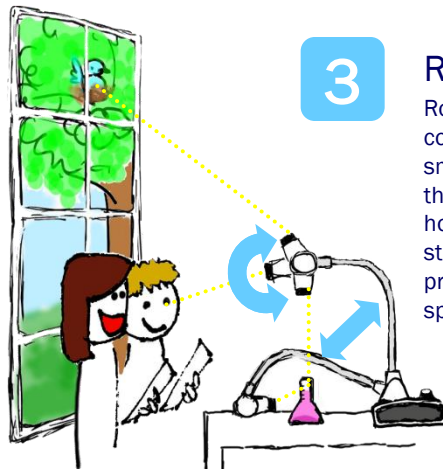

4 Capture and Review

Pause the camera image.
Press again to unfreeze.

C. Review saved images

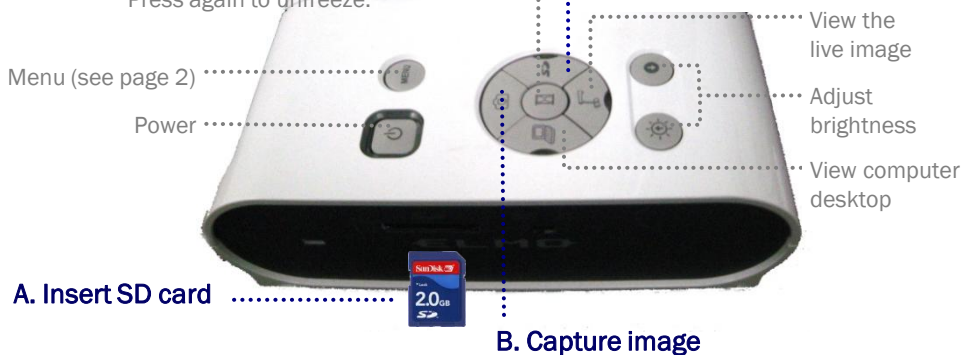

Capture the image of worksheets, student work, etc. and save them on the SD card. Quickly and easily review later during class by pressing the SD button.

5 Control the TT-02RX from anywhere in the classroom

Power [Red button]

Zoom [Orange button]

Adjust brightness [Dial]

View images/videos from SD card [Blue buttons]

Take a picture and save to SD card [Camera icon]

Future accessory [Green button]

Return to live image [Green button]

Auto-focus: Press after zooming

The **Highlight** allows you to emphasize a specific area of the image. Move the highlight using arrow buttons [▲][▶][▼][◀].

The **Mask** feature lets you to hide the answer to a written problem or following along when reading text, etc. To move the mask, use [▲][▶][▼][◀].

Press the **Scroll** to zoom instantly then use [▲][▶][▼][◀] to scroll around your image.

Picture-in-Picture Compare the live image to the paused image.

View computer desktop

6 Additional Menu features

Press to see all features

Scroll

Preset the scroll to 2X, 3X, or 4X zoom. You can quickly zoom and scroll around the image by pressing Scroll on the remote.

Slide Show Setting

Press [SD card] then [Menu]
Start a slideshow of the images from your SD card. Choose the interval time, order, and which images to play, etc.

Microscope

Connect your microscope using the provided adaptor and set to Microscope mode to view slides. Zoom, capture images and record video.

7 Install Image Mate software

Connect the TT-02RX to a computer and install Image Mate to **save images and videos to the computer**. You can also **annotate on the live image and record time-lapse photography** (set interval time in Settings before beginning time-lapse)

Remote to control the document camera from the desktop

Open previously saved files

Select the time-lapse interval, file format, etc.

Take a picture and save to computer

View live image

Record video and time-lapse photography

ELMO

Download Image Mate at
<http://www.elmousa.com/support/101>